

## Props

Prop inner tube 48.3mm O.D. and outer tube 60.3 O.D. tube. We supply 5 different sizes of props.

Size No.0	1000-1800mm
Size No.1	1750-3120mm
Size No.2	1980-3350mm
Size No.3	2590-3950mm
Size No.4	3200-4870mm



## U head hat

U head hat with spigot is to fit into prop to provide a U shape top, to support two bearers in place.



## Prop pin

One of the easy lost parts of props is the prop pin. We have them in stock for our customer needs.



## Prop nut

Prop nut is also available from us.



## Folding Tripod

This Tripod is prop standing bracket. It is always used as a reinforcement of prop. It can be folded to make transport and storage easy.



## A Shoring Frame system

A Shoring Frame system is a simple formwork slab system. The frames are made from galvanised steel tube. The outside diameter is 60mm. The WLL is 4 tons. Frame width is 1.2m. With cross braces, the system gives about 1.5m span from frame to frame. This system is comply to AS3610.



## Frames

Frame sizes are available as

- 1.8m high
- 1.5m high
- 1.2m high
- 0.9m high



## Cross Braces

Cross braces are light weight tubular crossbrace, used to brace frames and control the distance between frames. Used for both A shoring frames and H frames.



## Hollow jacks

Hollow shoring jack is for the base of the frame with O.D. 48mm

Length 750mm with stop point at 150mm

Hollow shoring U Head Jacks are for the top of the frame system with O.D. 48mm. The U-head jacks are available two sizes.

U-head jacks sizes:

- 750mm with stop point at 150mm
- 1200mm with stop point at 150mm



## Connector (Spigot)

H frame connector spigot made from galvanised steel tube. It is used in conjunction with H frames to vertically conjunction/joint on the frames.



## H Frame system

H Frame system is a simple formwork shoring system. The frames are made from galvanised steel tube. The tested WLL is 4.4 tons per leg when the jacks open at 380mm. Frame width is 1.2m. With cross braces, the system gives about 1.5m span between frames. This system is comply to AS3610.



## Frames

Frame sizes are available as

- 2.1m high
- 1.8m high
- 1.2m high
- 1.0m high



## Cross Braces

Cross braces have three different sizes. They keep the span from frame to frame to be about 1.5m.

- 2.1m cross brace use with 1.8m frame
- 1.7m cross brace use with 1.2m frame
- 1.6m cross brace use with 1.0m frame



## Hollow jacks

Hollow Jack is for the base of the frame. Hollow U Head Jack is for the top of the frame system. Our scaffolding solid jack and U head jacks can also do the same job.



## Connector (Spigot)

H frame connector spigot made from galvanised steel tube. It is used in conjunction with H frames to vertically conjunction/joint on the frames.



## Coil Ties

Coil Ties are used in conjunction with plastic cones to provide a combined spacer and tying system for wall construction.

It is made from steel. Our Coil Tie sizes are from 150mm to 650mm.

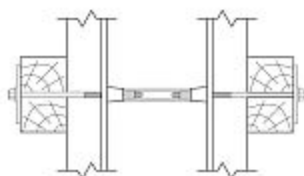

Typical Applications



## Coil Tie Bolts

Our coil tie bolts made from high tensile steel.

Lengths we supply:

250mm  
300mm  
350mm



## Plastic Cones

Coil Tie Cones are made from plastic. The cones are screwed on the coil tie spring.



## Washer/Plate

The plate washer is used outside the timber bearings.

Size 125X100X8mm  
100X100X8mm



## Coil Tie Tool

This Coil Tie Tool is used to tighten and remove coil tie bolts and also to remove coil tie cones. It makes the job easier and faster.



## Bar Tie Rod

This hot rod bar is manufactured from high grade steel. The rods need not be cut to be exact each job. The rod is a continuously threaded hot rolled and mill treated bar intended for formwork.



## Wing Nuts

Wing Nuts are used to spin freely on hot rod thread by hand and may be tightened using either an AF spanner or a length of bar.

Wing nuts are cast steel, which have 15mm diameter hole suit to our rods.



## Hexagan Nuts

The longer Hexagan Nuts can be used to joint bars where the greater lengths are required (or for economical use of cut). It remains buried in the concrete.

The shorter hexagan nuts can be used as wing nuts.

The diameter of the holes on the nuts are 15mm. We have Three sizes on height:

- 120mm
- 50mm
- 25mm



## Washers/Plates

We have two Washers/Plates. One is cast steel and the other is steel plate.



## Wing Nut with Plate

Heavy Duty Wing nut with plate is for slight angle of bar application.



## Water Stop Connector

Water Stop Connector is used to provide a water tight seal between the two sides of a concrete wall.



## Steel Cone

Steel Cone is use in bar tie wall system.



## Concrete Anchor

Expansion anchor can be used in concrete and rock in both wet and dry.



## Plastic Fillet

Made from a flexible plastic.

Size:3m/pc or in bundle



## PVC Conduit & Cone

The PVC conduit and plastic cones is to make the spacer at bar tie system.



## Bullet head nails

Bright finish Bullet Head Nails come in 25 Kg and 15 Kg boxes.

Size:

- 30mm X 1.8mm
- 50mm X 2.8mm
- 75mm X 3.75mm



## Long Hammer

Designed to nail in hard to reach places it will hammer all nails up to 75mm long and 6mm diameter and punch them up to 3mm deep. The magnetic barrel hold the nail in the tool so that you can nail up, down or sideways and reach in anywhere you can't swing a hammer.



## Formwork Plywood

Formwork plywood supply in following specifications:

- Size: 2400X1200X17mm
- 1800X1200X17mm

Grade: F17



## LVL Bearer

LVL Bearer size:

Size:

- |          |                 |
|----------|-----------------|
| 95X65mm  | 65 pcs per pack |
| 150X77mm | 35 pcs per pack |

Length: 3.6m, 4.2m, 4.8m, 5.4m, 6.0m



## Form Board

- |                |                 |
|----------------|-----------------|
| Size: 100X36mm | 90 pcs per pack |
| 120X36mm       | 81 pcs per pack |
| 150X36mm       | 63 pcs per pack |
| 170X36mm       | 54 pcs per pack |
| 200X36mm       | 45 pcs per pack |
| 240X36mm       | 36 pcs per pack |
| 300X36mm       | 27 pcs per pack |

Length: 6.0m

